

Door blank with Mahogany veneer / 110 mm stiles and rails / 4 mm SBD

Facing:	1,5 mm Mahogany veneer on cross banded plywood with 0,3 mm aluminium
Stiles:	110 mm finger joint mahogany timber
Rails:	110 mm finger joint mahogany timber
Core:	Polystyrene insulation + 2x4 mm plywood SBD

U-Value - W/m ² K									
60 mm	68 mm								
0,94	0,84								

Heat conductivity is calculated on the basis of the practical heat conductivity of each included material - taken from data sheets and DS418:2011

Weight appr. Kg./m ²									
60 mm	68 mm								
24,5	26,4								

Size 1000 x 2000 mm.

Performance:	Classification standards	Performance
Operating Forces	EN12217	Class 5
Climatic Influences	EN12219	Class 3
Security	EN1627 / EN1628-30	N/A
Sound	EN10140-2	22 dB
Fire	EN13501-2 / EN1634-1	N/A
FSC Certified	FSC-STD-40-004 V2-1/FSC-STD-50-001 V1-2	N/A

General tests has been carried out on a 68 mm. door blank with chen-chen veneer.
Sound tests has been carried out on a 60 mm. door blank with chen-chen veneer.
Size 1000 x 2100 mm. Stiles and rails 55 mm.

Measure: Min.: 250 x 450 mm - Max.: 1200 x 2400 mm

Tolerances:	
Door blank:	Width/Height: +/- 1 mm - Diagonal: +/- 2 mm - Thickness: +/- 0,8 mm
Facing:	Measurements on facing is before final sanding
Stiles and rails:	Width: +/- 2 mm
Core:	Inserts: +/- 1 mm on plywood

Elevation and section drawing:

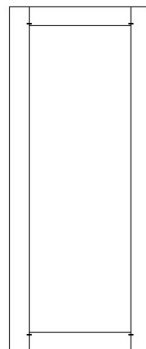

Stiles and rails: Front perspective

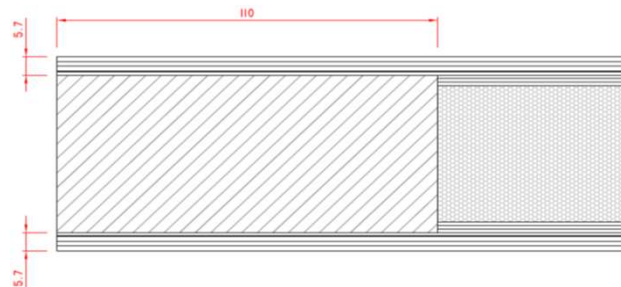

Made: 28.06.2021	Data sheet: CRS	Draw.: CRS
Revised: 01.12.2021	Data sheet: CRS	Draw.: CRS