

Acoustic Door - Rating 42 dB

Door blank with Chen-Chen veneer - 110 mm stiles and rails

Construction	1,5 mm Chen-Chen veneer	
	1,5 mm cross grain veneer	
	1,5 mm long grain veneer	
	0,3 mm Aluminium - moisture barrier - stabilizer	
	1,5 mm long grain inner veneer	
	4,0 mm HDF	(Appr. 970 kg/m ³ - heat conductivity: 0,13 W/mK)
	Insulation - 16,5 mm Sonitus 193	(Appr. 500 kg/m ³ - heat conductivity: 0,091 W/mK)
	Insulation - 15,6 mm Polystyrene, XPS	(Appr. 33 kg/m ³ - heat conductivity: 0,034 W/mK)
	Insulation - 16,5 mm Sonitus 197	(Appr. 1000 kg/m ³ - heat conductivity: 0,156 W/mK)
	4,0 mm HDF	(Appr. 970 kg/m ³ - heat conductivity: 0,13 W/mK)
1,5 mm long grain inner veneer		
0,3 mm Aluminium - moisture barrier - stabilizer		
1,5 mm long grain veneer		
1,5 mm cross grain veneer		
1,5 mm Chen-Chen veneer		

U-Value:	U-Value - W/m²K
	68 mm
	1,29 (calculated, not tested)

Size 1000 mm x 2000 mm
Heat conductivity is calculated on the basis of the practical heat conductivity of each included material - taken from data sheets and DS418, version 6, 2002. Also relating to EN 12524.

Weight:	Weight appr. Kg./m²
	68 mm
	43,2 (calculated, not tested)

Size 1000 mm x 2000 mm

Sound reduction:	Weighted sound reduction - R_w (C; C_{tr})= 42 (-1; -4) dB
	68 mm
	42

Weighted sound reduction index in accordance with PN-EN ISO 717-1:2013

Measure: Min.: 250 x 450 mm - Max.: 1200 x 2400 mm

Tolerances: Width/Height: +/- 1 mm - Diagonal: +/- 2 mm - Thickness: +/- 0,8 mm

Section drawing:

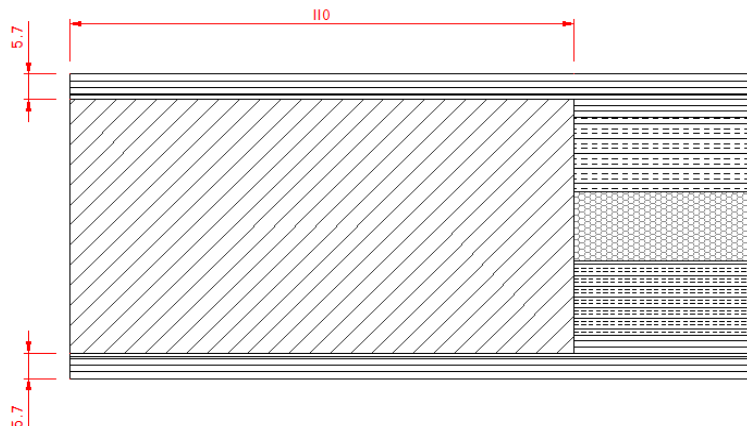

O.H.Industri A/S
Smedevej 17
DK - 7430 Ikast
+45 9725 1200
www.ohindustri.com

Made: 31.01.2018	Data sheet: CRS	Draw.: CRS
Revised: 14.09.2020	Data sheet: OLN	Draw.: