

Door blank with Oak veneer - 110 mm stiles and rails

Construction: 1,5 mm Oak veneer
 1,5 mm cross grain veneer
 1,5 mm long grain veneer
 0,3 mm Aluminium - moisture barrier - stabilizer
 1,5 mm long grain inner veneer
 Insulation - Polystyrene
 1,5 mm long grain inner veneer
 0,3 mm Aluminium - moisture barrier - stabilizer
 1,5 mm long grain veneer
 1,5 mm cross grain veneer
 1,5 mm Oak veneer

U-Value:	U-Value - W/m ² K									
	54 mm	60 mm	68 mm	78 mm	88 mm					
	1,21	0,92	0,83	0,73	0,66					

Size 1000 mm x 2000 mm

Heat conductivity is calculated on the basis of the practical heat conductivity of each included material - taken from data sheets and DS418, version 6, 2002. Also relating to EN 12524.

Weight:	Weight appr. Kg./m ²									
	54 mm	60 mm	68 mm	78 mm	88 mm					
	20,8	22,3	24,2	26,7	29,1					

Size 1000 mm x 2000 mm

Measure: Min.: 250 x 450 mm - Max.: 1200 x 2400 mm

Tolerances: Width/Height: +/- 1 mm - Diagonal: +/- 2 mm - Thickness: +/- 0,8 mm

Section drawing:

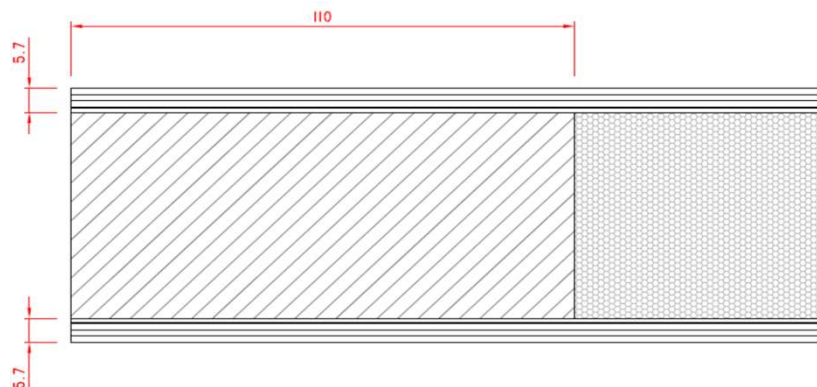

Made: 05.03.2014	Data sheet: PMN	Draw.: HMN
Revised: 20.09.2019	Data sheet: CRS	Draw.: HMN

O.H.Industri A/S
 Smedevej 17
 DK - 7430 Ikast
 +45 9725 1200
www.ohindustri.com