

## Panels MDF/Tricoya

- Construction:** 12 mm MDF ( Appr. 730 kg/m<sup>3</sup> - heat conductivity: 0,13 W/mK )  
 Meets the standards of "Symbol H" - cf. DS/EN 316 and DS/EN 622-5 concerning MDF sheets
- Insulation - Polystyrene ( Appr. 33 kg/m<sup>3</sup> - heat conductivity: 0,035 W/mK )
- 12 mm Tricoya ( Appr. 720 kg/m<sup>3</sup> - heat conductivity: 0,13 W/mK )  
 Meets the standards of "Symbol H" - cf. DS/EN 316 and DS/EN 622-5 concerning MDF sheets

U-Value:		U-Value - W/m <sup>2</sup> K									
45 mm	50 mm										
1,05	0,91										

Heat conductivity is calculated on the basis of the practical heat conductivity of each included material - taken from data sheets and DS418, version 6, 2002. Also relating to EN 12524.

Weight:		Weight appr. Kg./m <sup>2</sup>									
45 mm	50 mm										
18,1	18,3										

**Measure:** Min.: 120 x 250 mm - Max.: 1200 x 2400 mm

**Tolerances:** Width/Height: +/- 1 mm - Diagonal: +/- 1,5 mm - Thickness: +/- 0,8 mm

**Section drawing:**

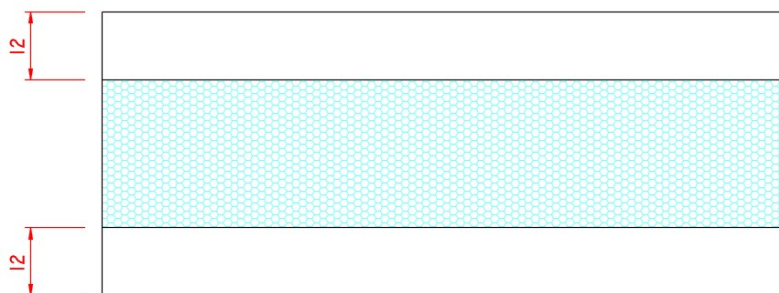

Made: 14.06.2019	Data sheet: CRS	Draw.: CRS
Revised:	Data sheet:	Draw.:

O.H.Industri A/S  
 Smedevej 17  
 DK - 7430 Ikast  
 +45 9725 1200